

AHD 1080P FULL HD Camera

SPECIFICATION

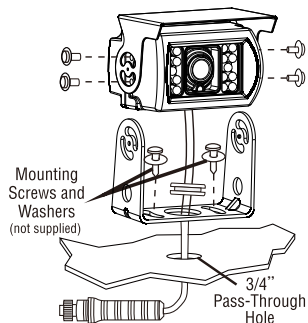

1705-00146



Mounting the Camera

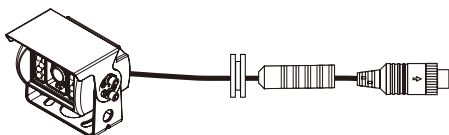
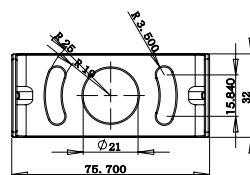
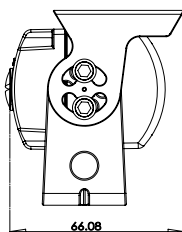
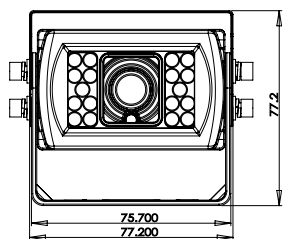

4-pin Female Connector Definition Aviation



1	Control Power (Red)
2	Ground (Black)
3	NG (White)
4	Video (Yellow)

Image pick-up Device	1/2.9 Color
TV System	NTSC/PAL
Lens Mount	2.8mm/120°
Horizontal Resolution	1080P
Sync System	Internal Synchronization
Number of Pixels	1920(H)X1080(V)
Usable Illumination	0.1 Lux At Night(IR LED ON)
IR Power On	CDS Auto Control, Under 10 Lux by CDS(≤10 Lux CDS ON)
Image Mode	Automatic Day/Night Switch
S/N Ratio	≥48dB(AGC Off)
Video Output	AHD1080P
Operation Temperature	-20℃-70℃ RH95%Max
Storage Temperature	-30℃-70℃ RH95%Max
Power Supply	DC12V/3W
Waterproof level	IP69K
Weight	400g